

# Office/Warehouse For Lease

## 327 N Hydraulic, Wichita, Kansas



## PROPERTY FEATURES

- 2,200 SF available
- 250 SF office in each suite
- 12' x 12' o/h door
- **\$1,700** / month  
(Industrial Gross)
- A/C in warehouse
- 1/4 mile to I-135 Hwy.
- Close proximity to all services
- General Commercial zoning



3450 N. Rock Road #201  
Wichita, KS 67226  
[amcwichita.com](http://amcwichita.com)

FOR INFORMATION  
Contact Ross Way  
**(316) 681-1711**  
[ross@amcwichita.com](mailto:ross@amcwichita.com)

# Office/Warehouse For Lease

## 327 N Hydraulic, Wichita, Kansas

### INTERIOR PHOTOS

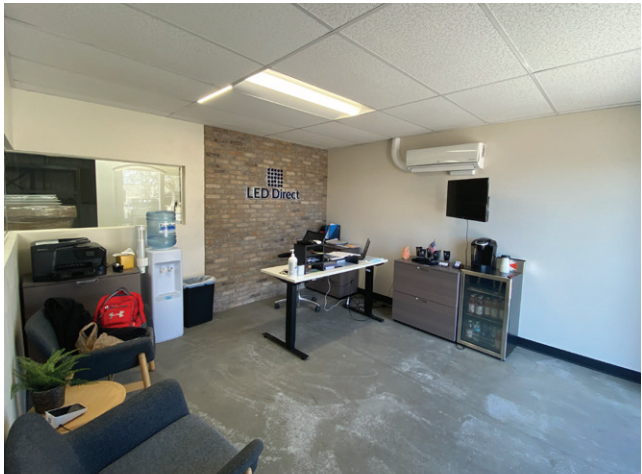

3450 N. Rock Road #201  
Wichita, KS 67226  
amcwichita.com

FOR INFORMATION  
Contact Ross Way  
**(316) 681-1711**  
ross@amcwichita.com

# Office/Warehouse For Lease

## 327 N Hydraulic, Wichita, Kansas

### FLOOR PLAN

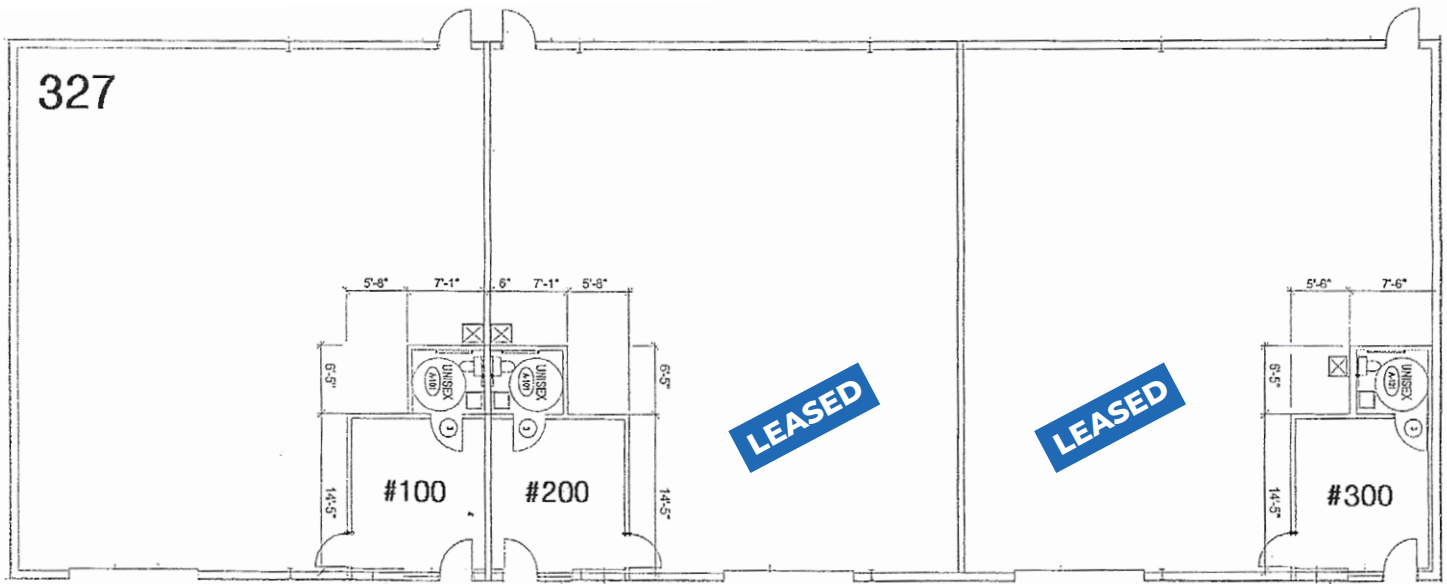

3450 N. Rock Road #201  
Wichita, KS 67226  
amcwichita.com

FOR INFORMATION  
Contact Ross Way  
**(316) 681-1711**  
ross@amcwichita.com

# Office/Warehouse For Lease

## 327 N Hydraulic, Wichita, Kansas

### LOCATION/AERIAL

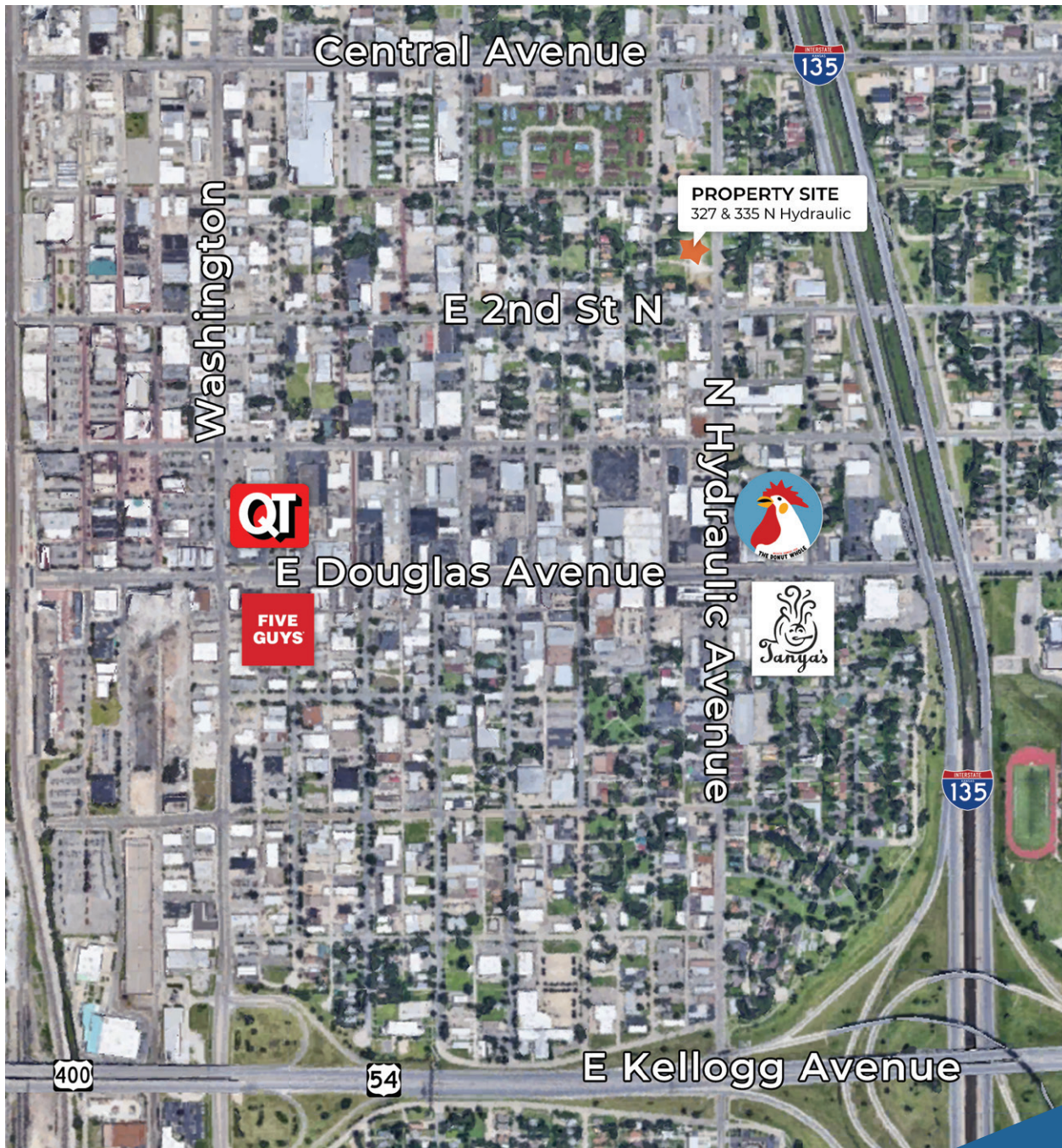

3450 N. Rock Road #201  
Wichita, KS 67226  
amcwichita.com

FOR INFORMATION  
Contact Ross Way  
**(316) 681-1711**  
ross@amcwichita.com